

Quick Start Guide



TinyLineMarker Sport

Version 2.1
Published 15 October 2022

1 Attach battery

- A Carefully slide the battery into the robot.



2 Turn on robot

- A Lock the battery and power on the robot using the battery key.

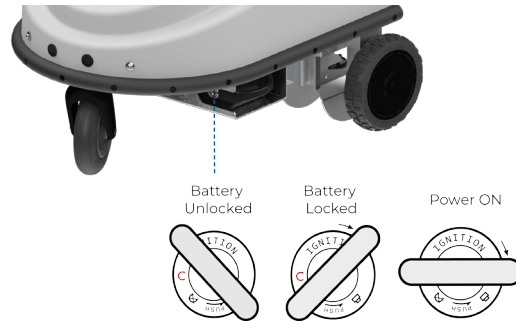

3 Turn on tablet

- A Press and hold the power button for 4 seconds until the screen lights up.

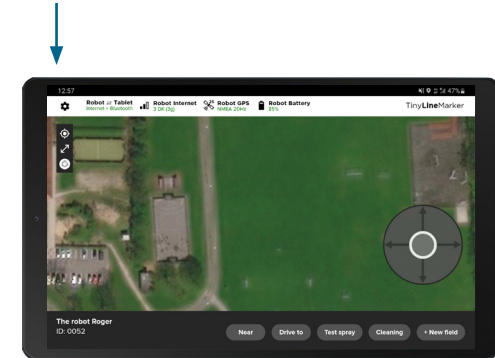

4 Mount container

- A Unscrew the large lid, pour the paint and fasten the lid again.
- B Insert the two hoses into the paint container and fasten the small lid.
- C Push the transparent suction hose to the bottom of the container.



5 Prime system

- A Press the yellow button to START the pump.
- B Paint will now be sucked into the suction hose. The system is primed when paint flows continuously back into the paint container.
- C Press and hold the blue button to prime the nozzle. Press the yellow button to turn off the pump.

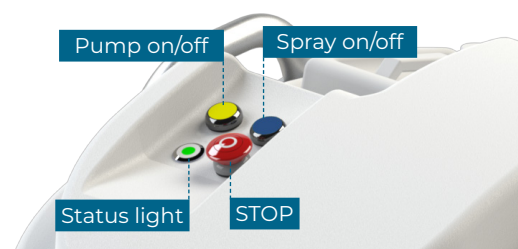

i The spray system must be primed prior to use to ensure best spray performance.

6 Adjust spray tool

- A Adjust the height of the spray tool, so the line width plates touch the top of the grass.
- B Adjust the height of the spray nozzle, so the paint just touches the edge of the line width plates.

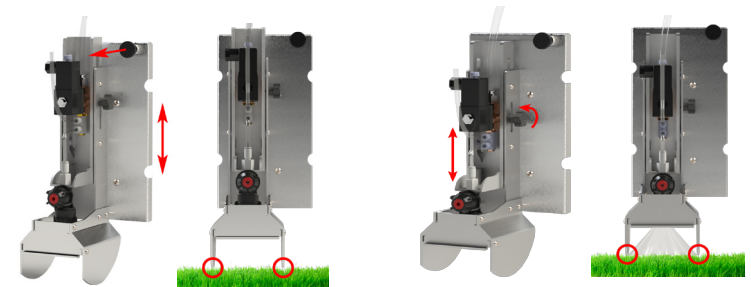

7 Create a new field

- A** Press **+New Field** to create a new field. This option is shown when no field is selected (Deselect a field by pressing outside the field).

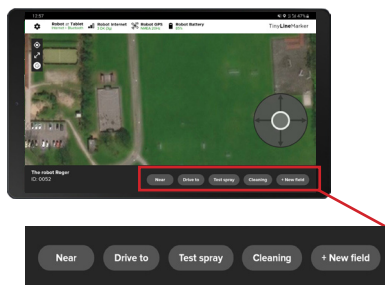

- B** Follow the on-screen instructions for creating the new field.

8 Test and start a field

- A** Select a field by pressing anywhere on or inside the field. The field turns yellow and allows you to Start, Test or Modify the Field.

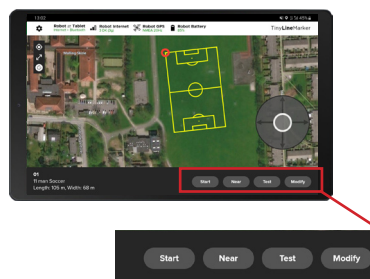

- B** Press **Test** to have the robot drive the field without painting it. There are 2 different test types:

1. Perimeter (fast) - Drives the field outline.
2. Complete field - Drives all the lines of the field.

- C** If the test was successful, press **Start** and the robot will paint the selected field.

- i** For the Perimeter test, the robot will run over the goal sockets. Therefore, this test is used if the field has fixed goal posts.

9 Cleaning after use

- A** Unscrew the small lid and remove the hoses from the paint container. Take out the blue return hose and place it back into the container. Press the yellow button. When paint is no longer flowing back into the container, press the yellow button again.

- B** Place the transparent suction hose in water and the blue return hose in a residual container. Press the yellow button to rinse the system.

- C** When clean water is coming out of the blue return hose, press and hold the blue button. This will activate and rinse the nozzle. When clean water is coming out of the return hose and nozzle, press the yellow button.



The robot must be cleaned according to these instructions after every use to avoid damaging the paint system.



10 Power off and charge batteries

- A** Turn the key to power off the robot. Push and turn the key to unlock the battery.

- B** Take the battery out of the battery rack.

- C** Insert the charger and charge the battery. The battery light will turn green when the battery is fully charged.

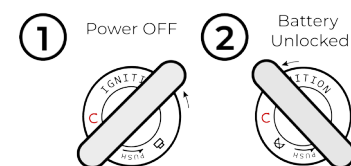

You are all set!

Enjoy your TinyLineMarker Sport.

For more information, please refer to the Help section in the TinyLineMarker app.

TinyMobileRobots®

tinymobilerobots.com

600-1013-02

